

New T-Clip Barb



Tying off wire, especially barb wire, can be awkward, timely and often untidy. The new Gripple T-Clip Barb removes the need to wrap or twist wire, making it safer and easier to install.

- Revolutionary new way to secure barb wire.
- Forget twisting, knotting or staples at the end-post.
- Suitable for use with wooden or metal end-posts.
- Simply twist onto the wire and push the tail end through.
- Up to four times faster than conventional methods.
- Professional, neat finish every time.



The Gripple T-Clip Barb is engineered for use on 12¹/₂ gauge (2.50mm) mild steel barb wire and 14 gauge (2.00mm) high tensile barb. For thinner, 15¹/₂ gauge (1.70mm) high tensile barb wire, use the standard Gripple T-Clip, that can also be used to terminate stock fence.

Tie off wire in seconds rather than minutes

1. Remove one or two barbs from the tail wire and wrap the barb wire around the post.
2. Twist and hook the Gripple T-Clip Barb onto the line wire (as close to the post as possible)
3. Push the tail wire through the T-Clip and pull the wire tight around the post.
4. Bend the tail wire back under the T-Clip to finish the installation.

Combine with the Gripple Barb to create a complete solution for terminating, joining and tensioning barb wire.

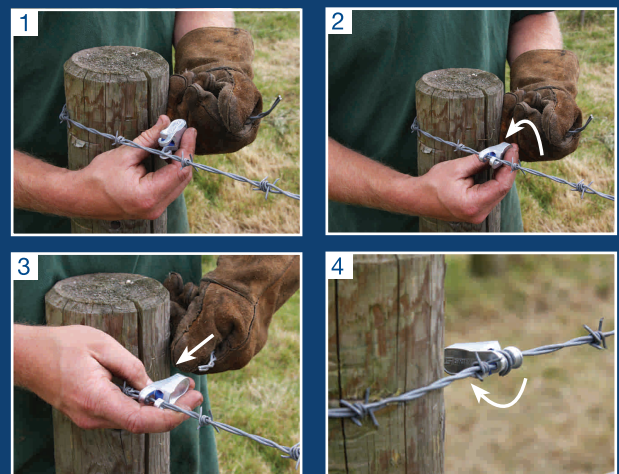

Barb Fencing



The Gripple Barb not only allows you to join barb wire quickly and effortlessly, but also apply tension.

- Join and tension barb wire in seconds.
- Re-tension easily year after year.
- No knotting, twisting or bending of awkward wire.
- Ideal for fast, economic repairs.

Gripple offers a complete solution to installing barb wire.

To terminate barb wire at an end post, the range of Gripple T-Clips suits both mild steel and high tensile barb wire. Then for joining and tensioning the barb wire, use either the Gripple Barb on 12½ - 14 ga. wire, or the Gripple Plus Medium on 15½ ga. wire.

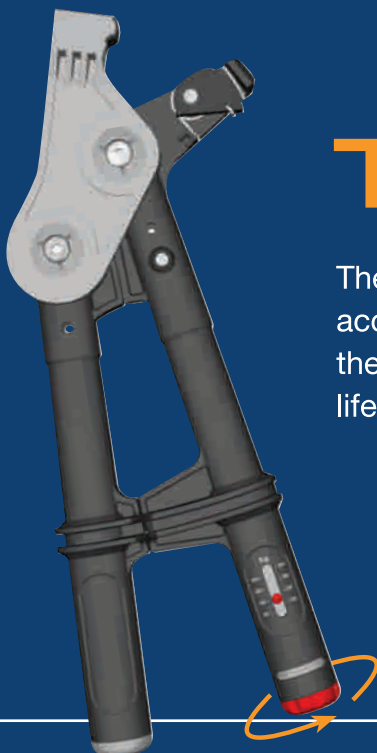
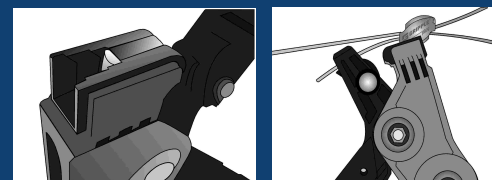
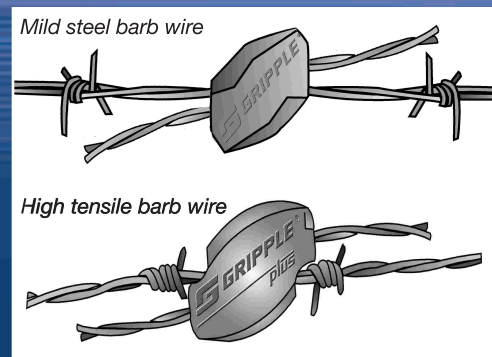

TORQ Tensioning Tool

The new improved Gripple Torq Tensioning Tool makes light work of applying accurate tension to your wire fence. The integrated torque setting regulates the load applied, delivering consistent results every time and maximizing the life of the wire.

- Now with settable tension gauge
- Measure from 50kg to 400kg
- Consistent tension every time
- Deliver up to 400kg with minimum effort
- New robust, lightweight design