

Fencing and Trellising
made easy



Whether installing, maintaining or repairing, **Gripple Plus[®]** is the fastest way to fence, trellis, brace and anchor.



Gripple Plus in Fencing

Gripple Plus significantly reduces the amount of time and labour needed to install and maintain your fence. It can be used on plain wire, barbed wire, stock fence and electric fence. Ideal for use at installation, the new Gripple Plus also offers a fast, economic solution if wires are damaged, when rapid repair is crucial for livestock management and safety.

Like the original Gripple, the Gripple Plus is a simple push-fit, there is no bending or twisting of wires, creating an instant joint that can then be tensioned using the Gripple Tensioning Tool.

The Gripple Plus is fitted with ceramic rollers that grip onto the wire. This engineering grade, high performance ceramic, delivers three key benefits to you:

1. Its corrosion resistance extends the life of the installation.
2. The tough, harder ceramic provides a better grip on today's high tensile wires.
3. And when it comes to maintenance and re-tensioning, the Gripple Plus performs better too.

In addition to these benefits, the Gripple Plus also offers an adjustment feature and improved load ratings.

Tensioning Tool

The Gripple Tensioning Tool is key to capitalising on the whole Gripple system. The hand-held tool is lightweight, compact and easy to use, and can deliver loads up to 400kg load. Its gear-drive mechanism provides a 6:1 mechanical advantage, resulting in maximum tension for minimum effort; allowing you to re-tension wires effortlessly time after time.

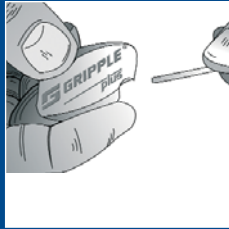

Simple push-fit

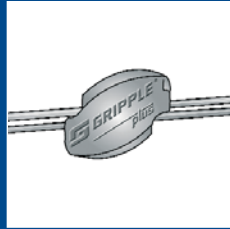

Plain wire

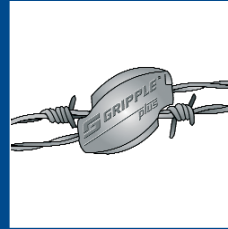

Barbed wire

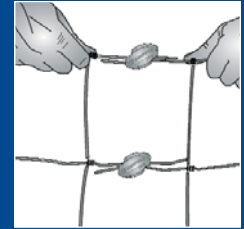

Netting



Gripple Plus in Trellising

Good quality materials are key to a trellis system that will last for years. The wire, posts and machinery used in today's vineyards are constantly being improved to deliver better results. Gripple Plus is part of this evolution and is the market leader in wire joiners/tensioners.

The Gripple Plus range offers increased load ratings on all three products, the GP Small, GP Medium and GP Large. This ensures that there is a product that not only meets your initial requirement, but the improved performance also offers you peace of mind when the crop is at its heaviest.

Again, the simple push-fit of the Gripple Plus means that the fruiting wires and foliage wires can all be installed and tensioned instantly. The ceramic mechanism offers improved resistance to sprays and weather conditions, and their intrinsic corrosion resistance also helps make re-tensioning the wires quick and easy to do.

Gripple Plus No.1

Many vineyards and orchards now use metal end posts in their trellis structures. The Gripple Plus No.1 is designed with one gripping channel, offering a bespoke solution to terminating and tensioning at the end post. Simply thread the wire through the metal end post and terminate with a Gripple Plus No.1.

Fruit Trellising

Although Gripple was first used in fencing and vineyards, the versatility and benefits of the product have been recognised and adopted by commercial fruit growers. Gripple Plus is strong enough to accommodate the heavy loads associated with growing apples, kiwi fruit, tomatoes, table grapes, raspberries and a wide variety of fruit and vegetables.

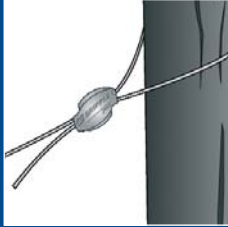

Loop

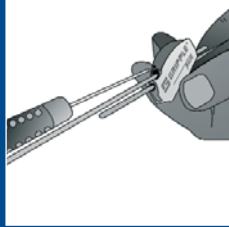

Adjustment key

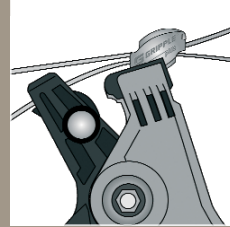

Tensioning



Bracing and Anchoring

A solid structure for a fence or trellis is essential for strength and life. Dependent on where you are in the world, different styles, formats and materials are preferred, but they all have one thing in common – strength.

The Gripple Plus Anchoring and Bracing Kits deliver this strength and are designed for use at an end post, common in vineyards and orchards, or for a H-post configuration, common in fence structures. The kit comes complete with a Gripple Plus unit and a length of wire rope with a pre-ferruled loop, making it fast and easy to install.

The high tensile wire rope is strong yet flexible, so is very easy to work with. The wire rope strength is a minimum of 1770Nmm² and conforms to EN13414-1:2003.

Kits are installed and tensioned within minutes and are suitable for use on metal, wood and concrete posts.

Again, these kits take advantage of the benefits of the new Gripple Plus:

- Corrosion resistance
- The superior toughness and precision teeth of the ceramic roller grip securely to support the initial trellis load and the plant growth thereafter
- The controlled movement of the ceramic roller within the Gripple Plus combats the effect of wind dynamics and motion

Lockable Gripple

For heavy-duty anchoring, bracing, or overhead trellis applications where dynamics may be involved, hail netting for example, the Lockable Gripple offers a reliable bespoke solution.

The Lockable Gripple has two screws that lock the gripping wedge in position, combating any movement within the structure. Ideal for use in tree bracing, hop trellis anchoring, shade cloth bracing etc.

The Lockable Gripple is available in kits or as single units. The kits come complete with wire rope that has the added benefit of a proven load rating for peace of mind.



Gripple Plus in Greenhouses/Poly-tunnels

More recently, the benefits of Gripple have been recognised for use in greenhouses and poly-tunnel applications. Installations not only include the traditional support wires for crops, but also support for shade cloth, sunscreens, drying wires (tobacco leaves for example), tray supports and many other support applications.

Gripple can be used on both steel wires and polymer wires, such as polyester or nylon. Quick and easy to install and to attach to the framework, the wires can be tensioned as normal using the Gripple Tensioning Tool.

Accessories

Gripple Setting Key

Use with the Gripple Plus Small, Medium and Large and Anchoring/Bracing Kits

Gripple Twister

The fast and easy way to tidy and secure tail wires

Gripple Workbelt

Handy workbelt complete with pockets for Gripples, tools, staples etc

Gripple Wire Cutters

Suitable for wire up to 4.00mm





**Starter Packs
(30% discount on
the Tensioning Tool)**

60 GP Small
50 GP Medium
30 GP Large
50 GP No.1
30 Jumbo
30 Barbed

**Tool Deals
(Tensioning Tool Free)**

300 GP Small
250 GP Medium
150 GP Large
200 GP No.1
120 Jumbo
200 Barbed

Product Range

Gripple	Wire – mm	Wire – SWG	Max. Load	Pack Size (Bag/Box)
Gripple Plus Small	1.40-2.20	17-13	300kg / 660lb	20 / 300
Gripple Plus Medium	2.00-3.25 2 x 1.70mm Barbed	14-10	400kg / 880lb	20 / 200
Gripple Plus Large	3.25-4.20	10-7 $\frac{1}{2}$	600kg / 1320lb	10 / 120
Gripple Plus No.1	1.80-3.00	15-11	400kg / 880lb	20 / 200
Gripple Jumbo	2.50-3.15	12 $\frac{1}{2}$ -10	600kg / 1320lb	10 / 120
Gripple Barbed	2 x 2.50mm Barbed	12 $\frac{1}{2}$ -Barb	150kg / 330lb	10 / 200

Anchoring/Bracing Kits

GPAK 3	3.0mm dia./4.5 metres	–	400kg / 880lb	10 / 80
GPAK 4	4.0mm dia./5.0 metres	–	600kg / 1320lb	6 / 48

Lockable Gripple

No.4 unit only	Use on 4.00mm (5/32") wire rope		400kg	2 / 80
No.5 unit only	Use on 5.00mm (3/16") wire rope		400kg	2 / 80
No.6 unit only	Use on 6.00mm (1/4") wire rope		800kg	2 / 40
No.5 kit	Kit with 4 metres of wire rope and Lockable Gripple No.5		1200kg Max.	2 / 16
No.6 kit	Kit with 6 metres of wire rope and Lockable Gripple No.6		2400kg Max.	2 / 16

For further details contact:

Gripple Ltd
The Old West Gun Works
Savile Street East
Sheffield S4 7UQ
England

Tel: +44 (0)114 275 2255
Fax: +44 (0)114 275 1155
Email: info@gripple.com

Gripple Inc.
1510 Hubbard Avenue
Batavia
Illinois 60510
USA

Tel: + 1 630 406 0600
Fax: + 1 630 406 0664

www.grippleplus.com

Gripple® and Gripple Plus® are registered designs and trademarks of Gripple Limited. World patented. Made in Sheffield, UK.
BROC-GPR-ENG-USA

G GRIPPLE®
plus